

4

3

2

NOTES:

1. IN [MM]
2. ALUMINUM CRYSTAL HOUSING
.020 [9,508] THK.
(CLEAR ALODINE FINISH)
3. B390 CRYSTAL
Ø1.500 [38,1] X 1.500 [38,1]
4. K+ GLASS OPTICAL WINDOW
.250 [6,35] THK.
5. ALUMINUM TOP CAP
(CLEAR ALODINE FINISH)
6. SEE MAN-690-001 FOR PIN-OUTS
& SPECIFICATIONS
7. PERFORMANCE SPECIFICATION:
PHR: 3.5% OR BETTER FOR CS-137 END-ON

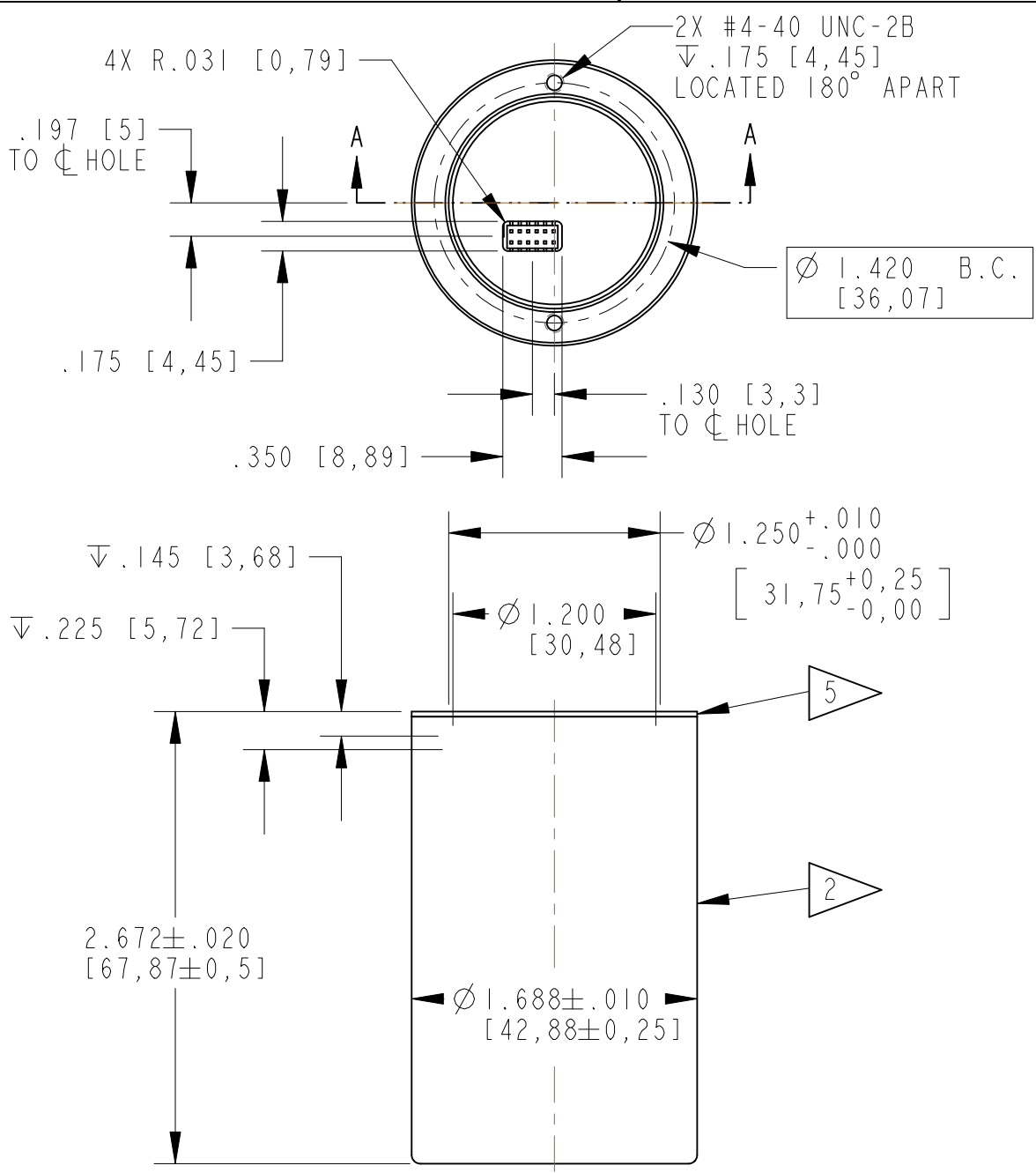

REVISIONS				
ZONE	REV.	DESCRIPTION	DATE	APPROVED
-	-	-	-	-

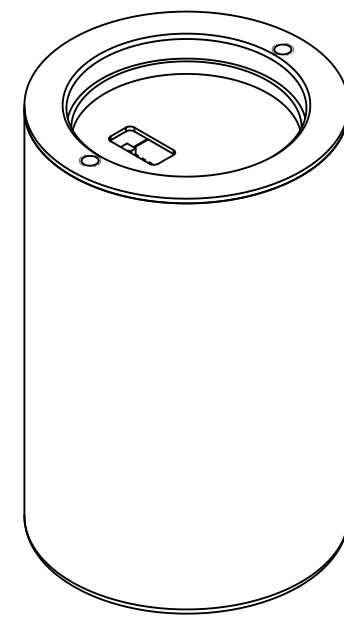

ISOMETRIC VIEW

SECTION A-A

METRIC TOLERANCES UNLESS OTHERWISE SPECIFIED

X	±2.5mm
X.X	±.25mm
X.XX	±.13mm
ANGLES	±0° 30'
MICRO FINISH	3.18 μm

US STANDARD TOLERANCES UNLESS OTHERWISE SPECIFIED

.X	±.100 in.
.XX	±.010 in.
.XXX	±.005 in.
ANGLES	±0° 30'
MICRO FINISH	125 μinches

CUSTOMER APPROVAL

APPROVED

APPROVED AS NOTED

REVISED & RESUBMIT

CUST. INIT. _____

DATE _____

ENGINEERING SALES DRAWING

DO NOT SCALE THIS DRAWING
THIS DWG IS IN ACCORDANCE
WITH ASME Y-14.5M

DRAWN	DATE
L. MARKS	04-Jun-20

THIS DOCUMENT IS APPROVED
AND MAINTAINED UNDER
ELECTRONIC CONFIGURATION
CONTROL

TITLE			
Si38.1BE38.ID35			
SIZE	PROJECTION	DWG. NO.	REV.
B		S690-1142	-
SCALE	APPROX. WEIGHT	SHEET	
1:1	0.62 LBS.	1 OF 1	

THIS PRINT IS THE EXCLUSIVE AND CONFIDENTIAL PROPERTY OF SAINT-GOBAIN CRYSTALS, A SUBSIDIARY OF SAINT-GOBAIN CERAMICS & PLASTICS, INC. AND IS NOT TO BE FURTHER REPRODUCED OR DISCLOSED TO ANOTHER PARTY WITHOUT PRIOR WRITTEN PERMISSION FROM SAINT-GOBAIN CRYSTALS. COPYRIGHT RESERVED, SAINT-GOBAIN CERAMICS & PLASTICS, INC. 2020

4

3

2

1