

4

3

2

NOTES: UNLESS OTHERWISE SPECIFIED

- 1. ALUMINUM CRYSTAL HOUSING
.020 THK. [0,508]
(CLEAR ALODINE FINISH)
- 2. NAI(TL) CRYSTAL
Ø1.500 [38,1] X 1.000 [25,4] THK.
- 3. Ø2.000 [50,8] PHOTOMULTIPLIER TUBE
ETI PART NUMBER 9266KB04FL OR EQUIVALENT

- 4. MU-METAL LIGHT SHIELD
.020 THK. [0,508]
(BARE METAL FINISH)

- 5. 14 PIN BASE

- 6. PERFORMANCE SPECIFICATION:
PHR: 8.5% OR BETTER FOR Cs-137
END-ON
HIGH VOLTAGE: +1000V TYPICAL

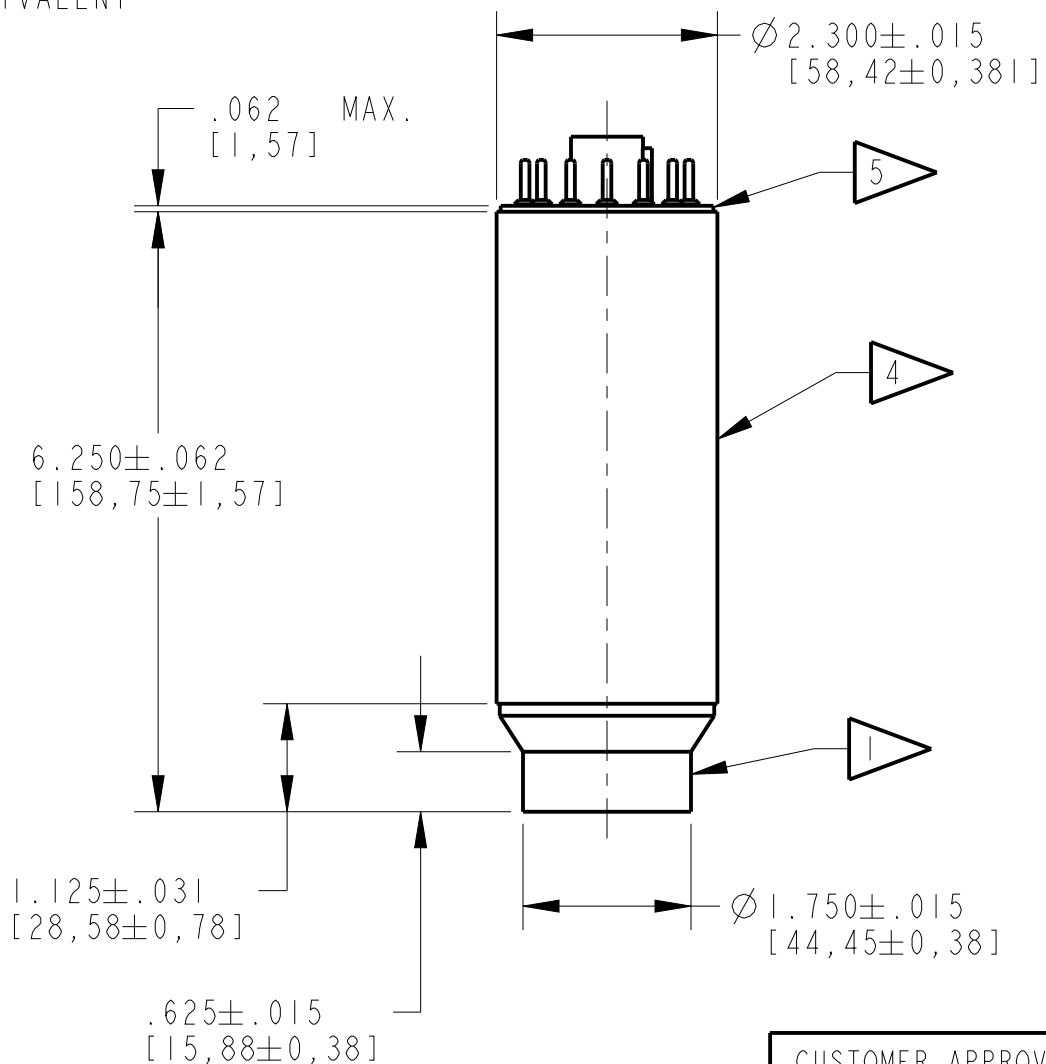
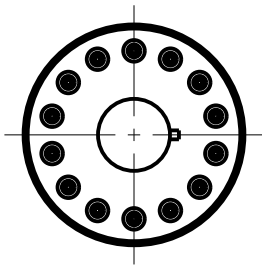

REVISIONS				
ZONE	REV.	DESCRIPTION	DATE	APPROVED
D4 C4	C	CLEAR ALODINE WAS BRIGHT CHROME BARE METAL WAS BRIGHT CHROME	1/22/15	IND. #2675

CUSTOMER APPROVAL

APPROVED

APPROVED AS NOTED

REVISED & RESUBMIT

CUST. INIT. _____

DATE _____

ENGINEERING SALES DRAWING

DO NOT SCALE THIS DRAWING
THIS DWG IS IN ACCORDANCE
WITH ASME Y-14.5M

DRAWN A.H. ERKER 12-Sep-97

THIS DOCUMENT IS APPROVED
AND MAINTAINED UNDER
ELECTRONIC CONFIGURATION
CONTROL

SAINT-GOBAIN
17900 Great Lakes Parkway, Hiram, OH 44234

TITLE
MODEL: 1.5MI/2

SIZE	CAGE CODE	DWG. NO.	REV.
B		SA-01204	C
SCALE	WEIGHT	CALC.	ACT. SHEET
0.500		<input type="checkbox"/>	<input type="checkbox"/> 1 OF 1

THIS PRINT IS THE EXCLUSIVE AND CONFIDENTIAL PROPERTY OF SAINT-GOBAIN CRYSTALS, A SUBSIDIARY OF SAINT-GOBAIN CERAMICS & PLASTICS, INC. AND IS NOT TO BE FURTHER REPRODUCED OR DISCLOSED OR INCORPORATED IN ANY OTHER PART OR WRITTEN INSTRUMENT OR FROM ANY SOURCE WITHOUT THE WRITTEN PERMISSION OF SAINT-GOBAIN CERAMICS & PLASTICS, INC. © 2015