

4

3

2

NOTES: UNLESS OTHERWISE SPECIFIED

REVISIONS				
ZONE	REV.	DESCRIPTION	DATE	APPROVED
D4 C4	B	CLEAR ALODINE WAS BRIGHT CHROME BARE METAL WAS BRIGHT CHROME	1/22/15	IND. #2675

1. ALUMINUM CRYSTAL HOUSING
(CLEAR ALODINE FINISH)

2. NAI(TL) CRYSTAL
Ø 1.000 [25,4] X
1.000 [25,4] THK.

3. Ø 2.000 [50,8]
PHOTOMULTIPLIER TUBE
ETI 9266 OR EQUIV.

4. MU-METAL LIGHT SHIELD
(BARE METAL FINISH)

5. 14 PIN BASE

6. PERFORMANCE SPECIFICATION:
PHR: 8.0% OR BETTER FOR Cs-137
END-ON
HIGH VOLTAGE: +1000V TYPICAL

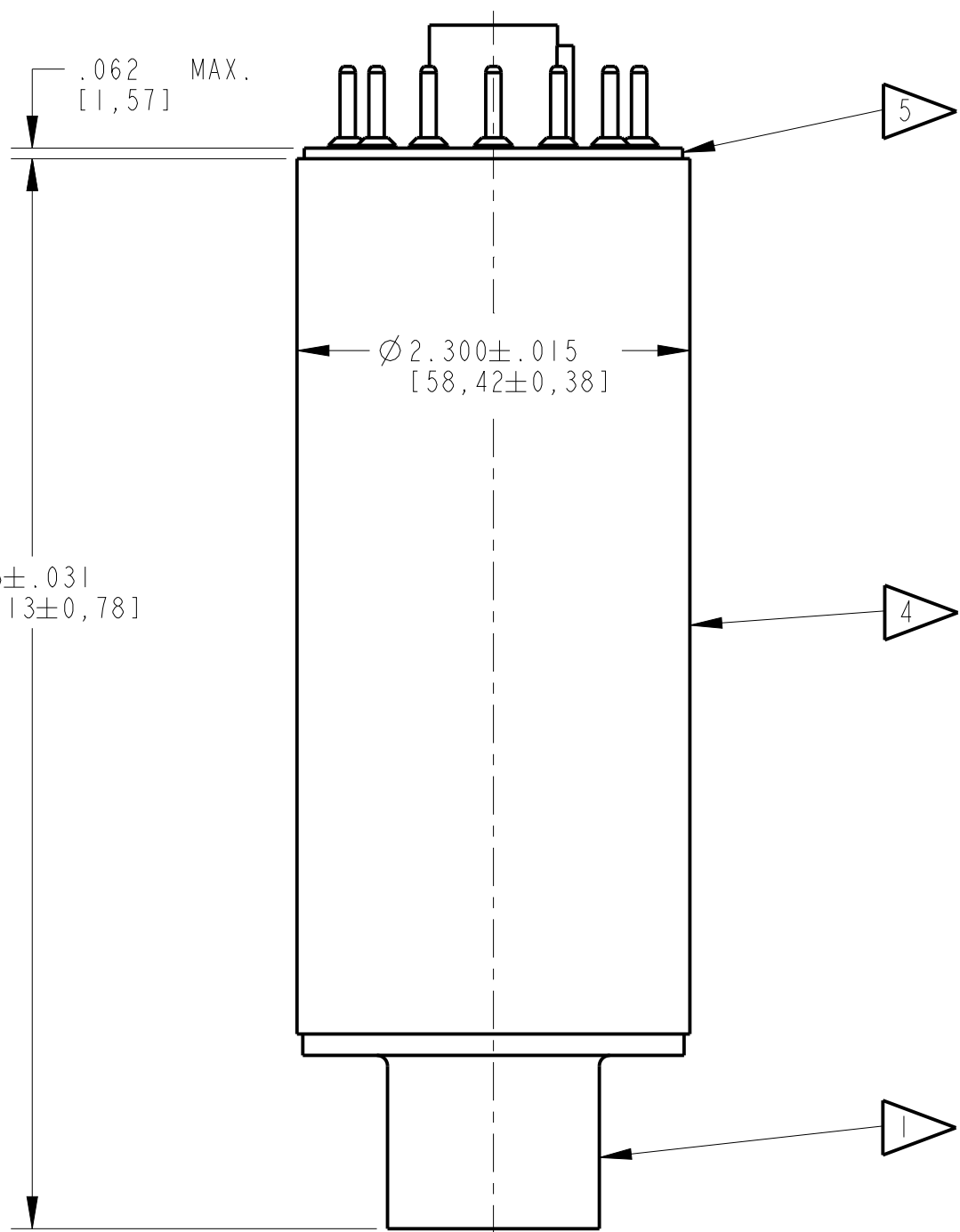

TOP VIEW

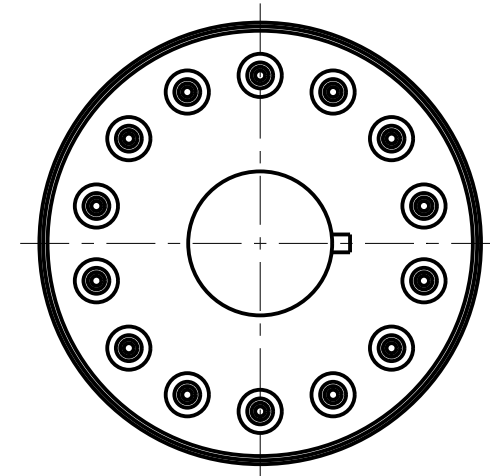

**THIS PRINT IS THE EXCLUSIVE AND CONFIDENTIAL PROPERTY OF SAINT-GOBAIN CRYSTALS, A
SUBSIDIARY OF SAINT-GOBAIN CERAMICS & PLASTICS, INC. AND IS NOT TO BE FURTHER REPRODUCED
OR DISCLOSED OR INCORPORATED IN ANY OTHER PRINT OR WRITTEN OR ELECTRONIC MEDIUM
WITHOUT THE WRITTEN PERMISSION OF SAINT-GOBAIN CERAMICS & PLASTICS, INC. © 2015**

CUSTOMER APPROVAL

APPROVED

APPROVED AS NOTED

REVISED & RESUBMIT

CUST. INIT. _____

DATE _____

ENGINEERING SALES DRAWING

DO NOT SCALE THIS DRAWING
THIS DWG IS IN ACCORDANCE
WITH ASME Y-14.5M

DRAWN J.W. 11-Nov-77

THIS DOCUMENT IS APPROVED
AND MAINTAINED UNDER
ELECTRONIC CONFIGURATION
CONTROL

SAINT-GOBAIN
17900 Great Lakes Parkway, Hiram, OH 44234

TITLE
MODEL: IM1/2

SIZE	CAGE CODE	DWG. NO.	REV.
B		SA-05302	B
SCALE	WEIGHT	CALC.	ACT. SHEET
1:1		<input type="checkbox"/>	<input type="checkbox"/> 1 OF 1

4

3

2

1